

TECHNICAL SERVICE BULLETIN

MODELS: MAXJAX M6 AND M6K

SUBJECT: HYDRAULIC FITTING REPLACEMENT

The purpose of this Technical Service Bulletin is to describe a new Hydraulic Elbow Fitting to be used with your MaxJax.

Hydraulic Elbow Fitting

The container that comes with this TSB includes a Hydraulic Elbow Fitting (**FTG ELB 3/8" JIC MALE x 3/8" NPTF MALE, LONG**) that replaces the Hydraulic Elbow Fitting that came in the Parts Bag of your Lift. The Hydraulic Elbow Fitting connects to the Flow Divider.

The Hydraulic Elbow Fitting looks like this:

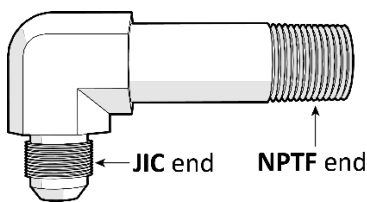

Discard the Hydraulic Elbow Fitting in the Parts Bag that came with your Lift. Instead, use the Hydraulic Elbow Fitting that comes with this TSB.

Installing the Hydraulic Elbow Fitting is described on Page 12 of Revision A1 of the MaxJax Manual.

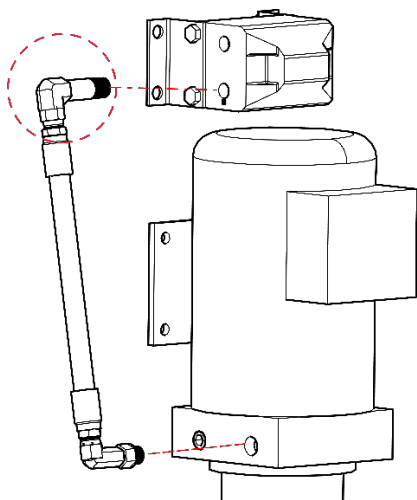

Note: The two Hydraulic Elbow Fittings look *very* similar; be careful to not mix them up. The only difference is the hole on the NPT end is slightly bigger on the Hydraulic Elbow Fitting that comes with this TSB.

If you have issues with your MaxJax Portable Lift, visit maxjax.com/support, email support@maxjax.com, or call **(844) 629-5291**.